

R

Schnittbild - Section Dwg.

R .. K.1,4.

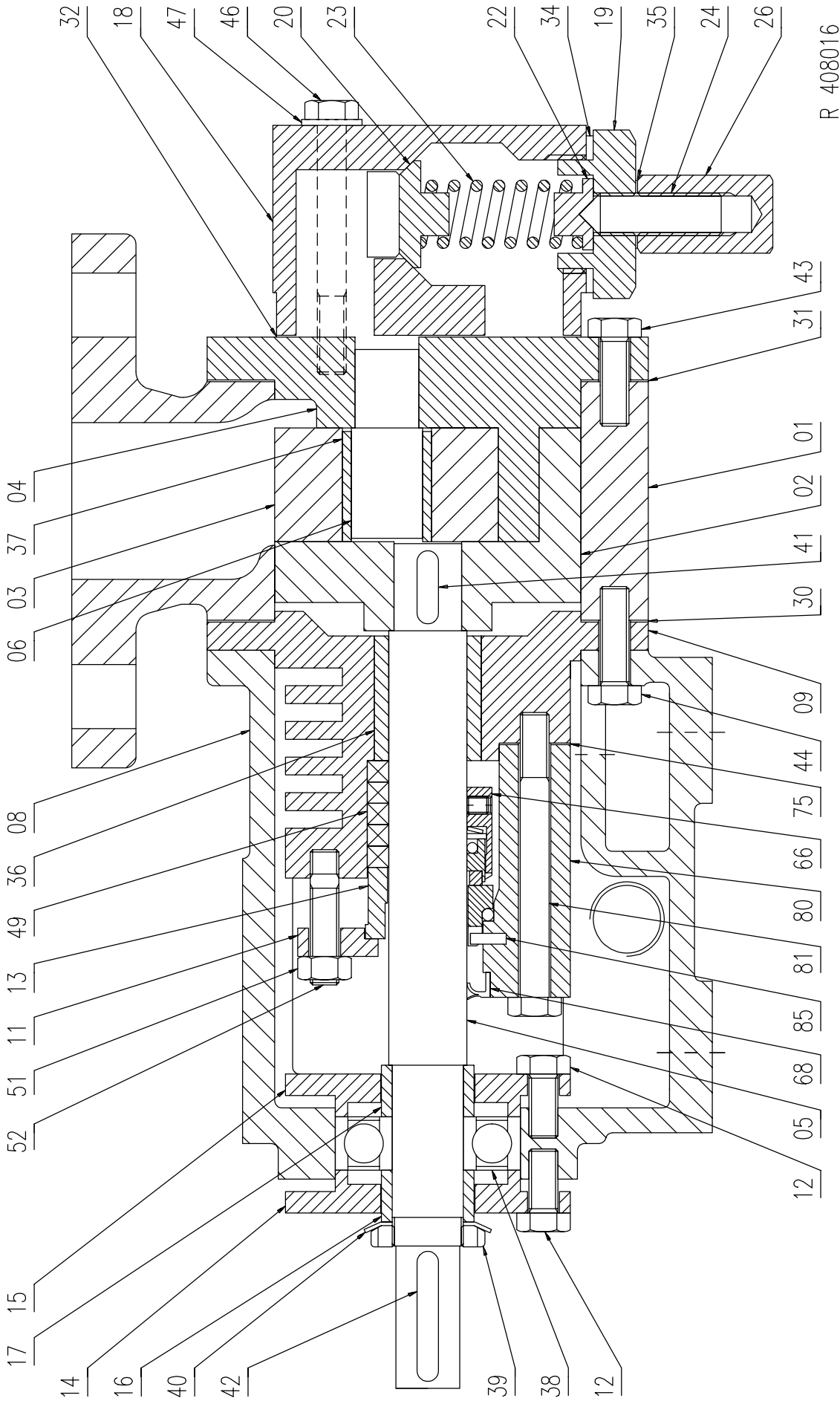

## R

## Spare Parts List

| Pos Ref. Rif. | Benennung                     | Part Name                  |  |  |
|---------------|-------------------------------|----------------------------|--|--|
| 01            | Gehäuse                       | Casing                     |  |  |
| 02            | Rotor                         | Rotor                      |  |  |
| 03            | Ritzel                        | Idler                      |  |  |
| 04            | Deckel                        | Cover                      |  |  |
| 05            | Welle                         | Shaft                      |  |  |
| 06            | Zapfen                        | Pin                        |  |  |
| 08            | Lagerbock                     | Bearing Housing            |  |  |
| 09            | Hinterer Deckel               | Rear Cover                 |  |  |
| 12            | Schraube, Lagerdeckel         | Screw, Bearing Cover       |  |  |
| 13            | Brille                        | Gland                      |  |  |
| 14            | Kugellagerdeckel              | Bearing Cover              |  |  |
| 16            | Distanzhülse                  | Sleeve                     |  |  |
| 18            | Gehäuse, By-Pass              | Casing, By-Pass            |  |  |
| 19            | Deckel, By-Pass               | Cover, By-Pass             |  |  |
| 20            | Ventil                        | Valve                      |  |  |
| 22            | Teller                        | Guide                      |  |  |
| 23            | Feder                         | Spring                     |  |  |
| 24            | Stell Schraube                | Setting Screw              |  |  |
| 26            | Kappe                         | Cap                        |  |  |
| 27            | Flansch, By-Pass              | Flange, By-Pass            |  |  |
| 30            | Dichtung, Gehäuse             | Gasket, Casing             |  |  |
| 32            | Dichtung, By-Pass             | Gasket, By-Pass            |  |  |
| 34            | Dichtung, By-Passdeckel       | Gasket, By-Pass Cover      |  |  |
| 35            | Dichtung, Kappe               | Gasket, Cap                |  |  |
| 36            | Gleitlager, Welle             | Bushing, Shaft             |  |  |
| 37            | Gleitlager, Ritzel            | Bushing, Idler             |  |  |
| 38            | Kugellager                    | Ball Bearing               |  |  |
| 39            | Nutmutter                     | Lock Nut                   |  |  |
| 40            | Sicherungsblech               | Washer                     |  |  |
| 41            | Paßfeder, Rotor               | Key, Rotor                 |  |  |
| 42            | Paßfeder, Welle               | Key, Shaft                 |  |  |
| 43            | Schraube, Deckel              | Screw, Cover               |  |  |
| 44            | Schraube, Gehäuse             | Screw, Casing              |  |  |
| 46            | Schraube, By-Pass             | Screw, By-Pass             |  |  |
| 49            | Packungssatz                  | Packing Set                |  |  |
| 51            | Schraube, Brille              | Screw, Gland               |  |  |
| 52            | Mutter, Brille                | Nut, Gland                 |  |  |
| 61            | Verschlussschraube            | Plug                       |  |  |
| 62            | Dichtung, Verschlussschraube  | Gasket, Plug               |  |  |
| 66            | Gleitringdichtung             | Mechanical Seal            |  |  |
| 75            | Dichtung, GLRD-Träger         | Gasket, Seal Box           |  |  |
| 80            | GLRD-Träger                   | Seal Box                   |  |  |
| 81            | Schraube, GLRD-Träger         | Screw, Seal Box            |  |  |
| 82            | Öler                          | Oil Lubricator             |  |  |
| 83            | Bogen                         | Bend                       |  |  |
| 85            | Kegelstift, Gleitringdichtung | Taper Pin, Mechanical Seal |  |  |

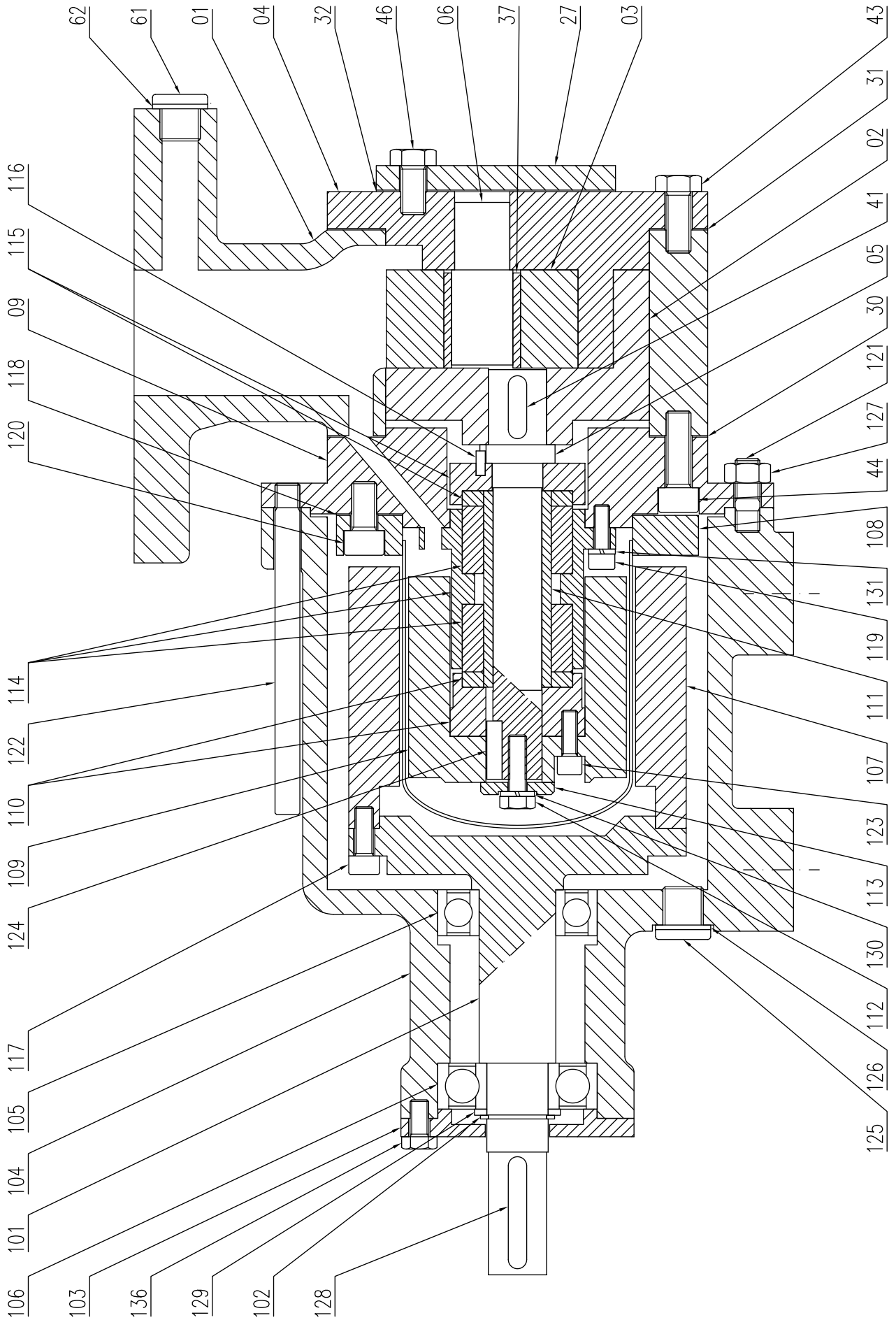

## R

## Spare Parts List

## Ersatzteilliste R ...M II

| Pos<br>Ref.<br>Rif. | Benennung                                     | Part Name                            |  |  |
|---------------------|---|--------------------------------------|--|--|
| 01                  | Gehäuse                                       | Casing                               |  |  |
| 02                  | Rotor   | Rotor                                |  |  |
| 03                  | Ritzel  | Idler                                |  |  |
| 04                  | Deckel  | Cover                                |  |  |
| 05                  | Welle   | Shaft                                |  |  |
| 06                  | Zapfen  | Pin                                  |  |  |
| 09                  | Hinterer Deckel                               | Rear Cover                           |  |  |
| 27                  | Flansch, By-Pass oder By-Pass                 | Flange, By-Pass or By-Pass           |  |  |
| 30                  | Dichtung, Gehäuse                             | Gasket, Casing                       |  |  |
| 31                  | Dichtung, Deckel                              | Gasket, Cover                        |  |  |
| 32                  | Dichtung, By-Pass                             | Gasket, By-Pass                      |  |  |
| 37                  | Gleitlager, Ritzel                            | Bushing, Idler                       |  |  |
| 41                  | Paßfeder, Rotor                               | Key, Rotor                           |  |  |
| 43                  | Schraube, Deckel                              | Screw, Cover                         |  |  |
| 44                  | Schraube, Gehäuse                             | Screw, Casing                        |  |  |
| 46                  | Schraube, By-Pass                             | Screw, By-Pass                       |  |  |
| 61                  | Verschlussschraube                            | Plug                                 |  |  |
| 62                  | Dichtung, Verschlussschraube                  | Gasket, Plug                         |  |  |
| 101                 | Welle, außen                                  | Shaft, outer                         |  |  |
| 102                 | Sicherungsring, Welle                         | Circlip, Shaft                       |  |  |
| 103                 | Lagerdeckel                                   | Bearing Cover                        |  |  |
| 104                 | Lagerbock                                     | Bearing Housing                      |  |  |
| 105                 | Kugellager, innen                             | Ball Bearing, inner                  |  |  |
| 106                 | Kugellager, außen                             | Ball Bearing, outer                  |  |  |
| 107                 | Magnet, außen                                 | Magnet, outer                        |  |  |
| 108                 | Spalttopf                                     | Can                                  |  |  |
| 109                 | Magnet, innen                                 | Magnet, inner                        |  |  |
| 110                 | Mitnehmer, außen mit Axial Gleitlager         | Collar, outer with Trust Ring        |  |  |
| 111                 | Wellenhülse                                   | Shaft sleeve                         |  |  |
| 112                 | Schraube, innen welle                         | Screw, inner shaft                   |  |  |
| 113                 | Scheibe, innen welle                          | Washer, inner shaft                  |  |  |
| 114                 | Lagerträger mit Radial Gleitlager SiC         | Bush Housing with Radial Bushing SiC |  |  |
| 115                 | Mitnehmer, innen mit Axial Gleitlager         | Collar, inner with Trust Ring        |  |  |
| 116                 | Stift, innen mitnehmer                        | Pin, inner collar                    |  |  |
| 117                 | Schraube, Magnet, außen                       | Screw, Magnet, outer                 |  |  |
| 118                 | Dichtung, Spalttopf                           | Gasket, Can                          |  |  |
| 119                 | Schraube, Lager Träger                        | Screw, Bush Housing                  |  |  |
| 120                 | Schraube, Spalttopf                           | Screw, Can                           |  |  |
| 121                 | Schraube/ Stiftschraube, Lagerbock            | Screw/ Stud, Bearing Housing         |  |  |
| 122                 | Führungsstange                                | Slide Bar                            |  |  |
| 123                 | Schraube, Magnet, innen                       | Screw, Magnet, inner                 |  |  |
| 124                 | Paßfeder, Magnet, innen                       | Key, Magnet, inner                   |  |  |
| 125                 | Verschlussschraube, Lagerbock                 | Plug, Bearing Housing                |  |  |
| 126                 | Dichtung, Verschlussschraube, Lagerbock       | Gasket, Plug, Bearing Housing        |  |  |
| 127                 | Mutter, Lagerbock                             | Nut, Bearing Housing                 |  |  |
| 128                 | Paßfeder, Welle, außen                        | Key, Shaft, outer                    |  |  |
| 129                 | Stutzscheibe                                  | Supporting ring                      |  |  |
| 130                 | Federring, Welle, innen                       | Spring Washer, Shaft, inner          |  |  |
| 131                 | Federring, Lagerträger                        | Spring Washer, Bush Housing          |  |  |
| 132                 | Verschlussschraube, Lagerbock (für Fühler)    | Plug, Bearing Housing (for sensor)   |  |  |
| 133                 | Dichtung, Verschlussschraube, Lagerbock       | Gasket, Plug, Bearing Housing        |  |  |
| 134                 | Verschlussschraube, hinterer deckel           | Plug, rear cover                     |  |  |
| 135                 | Dichtung, Verschlussschraube, hinterer deckel | Gasket, Plug, rear cover             |  |  |
| 136                 | Schraube, Lagerdeckel                         | Screw, Bearing Cover                 |  |  |